

DRAFT

**Texas General Land Office
CDBG-MIT Method of
Distribution (MOD)
Application
from**

City of Burton

DRAFT

PUBLIC NOTICE
City of Burton
COMMUNITY DEVELOPMENT BLOCK GRANT PROGRAM
TEXAS GENERAL LAND OFFICE
2022 METHOD OF DISTRIBUTION (MOD) APPLICATION
April 14, 2022

The City of Burton is giving notice of the City's intent to submit a Community Development Block Grant Program MOD Application(s) to assist the community with Mitigation efforts with installing a new water well for the City located at the existing water plant on Loop 125.

The total project allocation is \$593,800.00. This application is available for review on the City's website (<https://cityofburton-tx.gov/>) Citizens are welcome to review this application for a 14-day public comment period and provide all public comment to Angela Harrington via email at burtonsecr@cityofburton-tx.gov or at City offices located at Burton City Hall, 12200 East Mullberry Street Spur 125, Burton, Texas, 77835 during regular business hours.



City of Burton CDBG-MIT MOD Application

DRAFT

Project Description:

The City of Burton propose to construct New Water Well #5 near the intersection of Mulberry Street (Spur 125)/Brazos Street. Presently, the City of Burton only has 1 groundwater supply well for approximately 230 connections. To reduce risk and for mitigation purposes, if this one well is lost, there is no backup, so the City's citizens would be without water and water hauling would be the only alternative as there is no neighboring water system connection. Water Well #5 is proposed to provide a second well that will provide the City's water system with redundancy & resiliency. The new well will be pump groundwater to the City's existing water plant on Mulberry St (Spur 125) that already includes existing ground storage tank, booster pumps, building, electrical and controls. Without this proposed water well and if the existing well should fail, this lack of water would be a major health risk for current & future citizens and impose economic difficulties on the City's existing businesses. Without a reliable and resilient water supply, there would be no day-to-day living and businesses would cease to exist in the City of Burton.



CDBG-MIT: Budget Justification of Retail Costs (Former Table 2)

Cost Verification Controls must be in place to assure that construction costs are reasonable and consistent with market costs at the time and place of construction.

Applicant/Subrecipient:	City of Burton					
Site/Activity Title:	Existing Water Plant on Loop 125/New Water Well					
Eligible Activity:	Water Facilities					
Materials/Facilities/Services	\$/Unit	Unit	Quantity	Construction	Acquisition	Total
Water Well 5	\$ 400,000.00	LS	1	\$ 400,000.00	\$ -	\$ 400,000.00
Well Logging	\$ 15,040.00	EA	1	\$ 15,040.00	\$ -	\$ 15,040.00
Well Submersible Pump & Motor	\$ 60,000.00	EA	1	\$ 60,000.00	\$ -	\$ 60,000.00
	\$ -		0	\$ -	\$ -	\$ -
	\$ -		0	\$ -	\$ -	\$ -
	\$ -		0	\$ -	\$ -	\$ -
	\$ -		0	\$ -	\$ -	\$ -
	\$ -		0	\$ -	\$ -	\$ -
	\$ -		0	\$ -	\$ -	\$ -
	\$ -		0	\$ -	\$ -	\$ -
	\$ -		0	\$ -	\$ -	\$ -
	\$ -		0	\$ -	\$ -	\$ -
	\$ -		0	\$ -	\$ -	\$ -
	\$ -		0	\$ -	\$ -	\$ -
	\$ -		0	\$ -	\$ -	\$ -
	\$ -		0	\$ -	\$ -	\$ -
	\$ -		0	\$ -	\$ -	\$ -
	\$ -		0	\$ -	\$ -	\$ -
	\$ -		0	\$ -	\$ -	\$ -
	\$ -		0	\$ -	\$ -	\$ -
TOTAL	\$ 475,040.00			\$ 475,040.00	\$ -	\$ 475,040.00

1. Identify and explain the annual projected operation and maintenance costs associated with the proposed activities.

Anticipated annual operation and maintenance costs include electricity, disinfection chemicals and equipment checks. Electricity is estimated at \$5,000-\$7,500/year based upon running 8 hours per day. Chlorine costs are estimated at \$2,000-\$4,000/year based upon actual water pumping. Equipment checks and BacT testing are estimated at \$10,000/year.

2. Identify and explain any special engineering activities.

Secure 150' Sanitary Control Easement around new well or obtain variance



Bradley C Loehr
4/11/2023
F-2011

Seal

Date:	4/11/2023
Phone Number:	979-968-6474

Signature of Registered Engineer/Architect
Responsible For Budget Justification:

8.5" X 11"
GRAPHIC SCALE

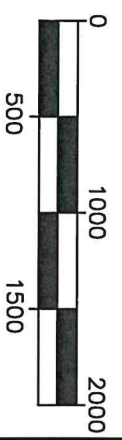

SCALE: 1"=1000'



LEGEND



New Water Well

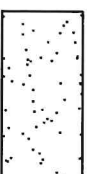

Approximate Location
of Zone 'A' Floodplain

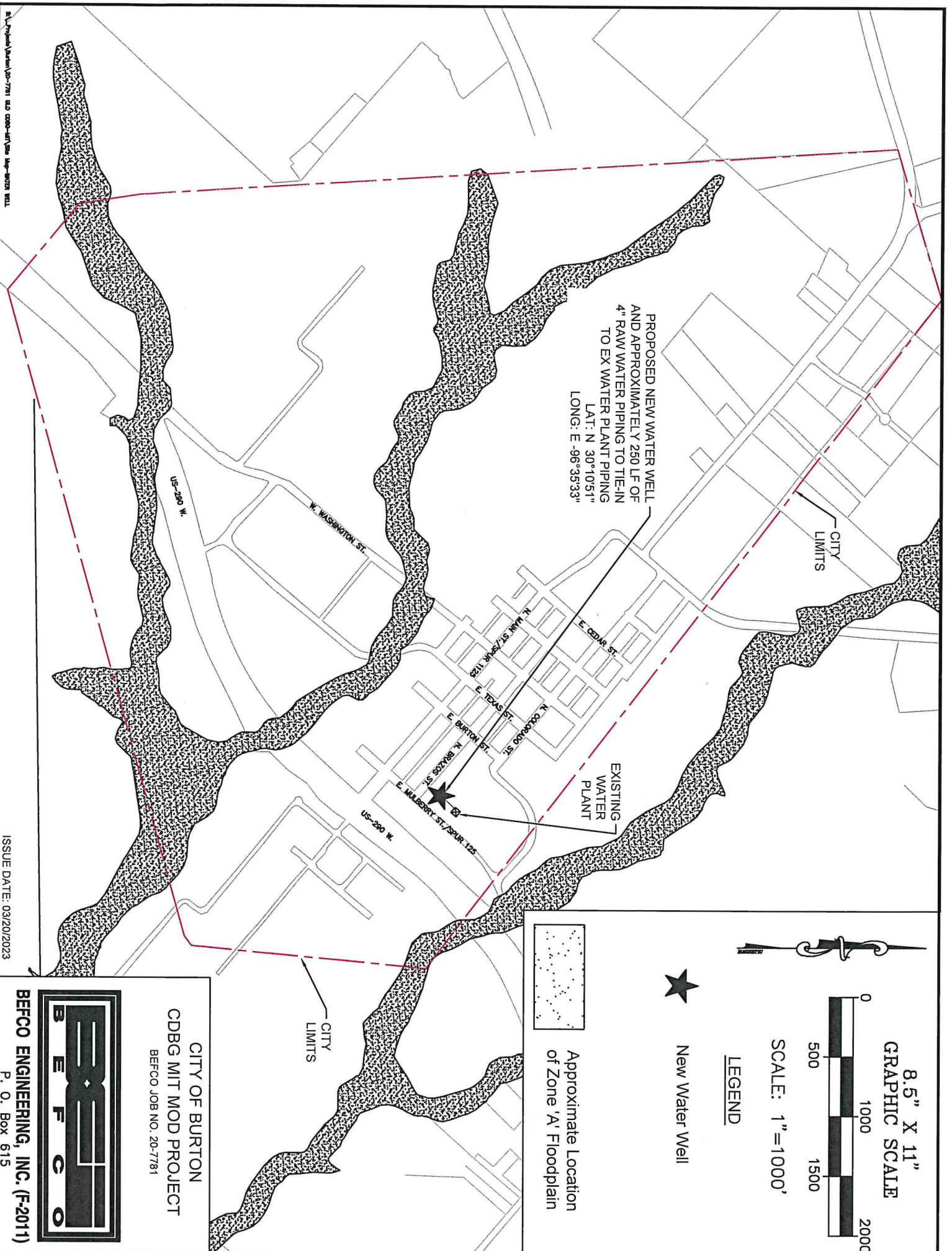

PROPOSED NEW WATER WELL
AND APPROXIMATELY 250 LF OF
4" RAW WATER PIPING TO TIE-IN
TO EX WATER PLANT PIPING
LAT: N 30°10'51"
LONG: E -96°35'33"

EXISTING
WATER
PLANT

CITY
LIMITS

CITY
LIMITS

CITY OF BURTON

CDBG MIT MOD PROJECT

BEFCO JOB NO. 20-7781



BEFCO ENGINEERING, INC. (F-2011)

P. O. Box 615

ISSUE DATE: 03/20/2023

St. Joseph (Burton) Job-7781 SLO CDBG-MIT MOD WATER WELL

TABLE 1 - CONTRACT BUDGET AND BENEFICIARY IDENTIFICATION

Provide comprehensive budget information to include construction, engineering, acquisition, environmental services, and administrative costs. Also include all other funds (FEMA, insurance, local, etc.) committed to the completion of the proposed projects.

A *project* is defined as a discrete combination of: entity (i.e., city or county), activity (i.e., water, sewer, etc.), beneficiary population, and national objective. A *site* is defined as a discrete location for activities within a project. A project can have one or more sites.

BUDGET TABLE:

Project Title:	Total Benes	LMI Benes	LMI %	CDBG-DR Construction	CDBG-DR Engineering	CDBG-DR Acquisition	CDBG-DR Environmental	CDBG-DR Admin	Total CDBG-DR Request	Other Funds	Activity Total
# 03j Water Well -City of Burton	387	204	52.71%	\$475,040.00	\$71,256.00	\$0.00	\$12,000.00	\$35,504.00	\$593,800.00	\$0.00	\$593,800.00
SUMMARY TOTALS:	387	204	52.71%	\$475,040.00	\$71,256.00	\$0.00	\$12,000.00	\$35,504.00	\$593,800.00	\$0.00	\$593,800.00

Beneficiary Identification Method(s) Per Project:

03j Project Title: Water Well

HUD National Objective: Benefiting low- and moderate- (L/M) income persons

Select One Benefit Type: City-wide Benefit ☒ County-wide Benefit ☐ Area Benefit ☐ Direct Benefit ☐

Select Beneficiary Identification Method:

- ☐ SURVEY: An approved TxCDBG survey was used to identify the beneficiaries for this activity.
- ☒ HUD LMISD information was used to identify the beneficiaries for this activity.
- ☐ The required Census or Texas State Data Center map has been provided.

Provide the number of beneficiaries identified through each of the following methods for this activity:

TxCDBG Survey: 0 HUD LMISD: 387 Area Benefit: 0 Housing Activity: 0 Limited Clientele: 0

Race	# Non-Hispanic Beneficiaries	# Hispanic Beneficiaries	Total Activity Beneficiaries
White	352	8	360
Black African American	21	0	21
Asian	3	0	3
Asian/White	3	0	3
	379	8	387
Gender	Total Males	Total Females	Total Benes
	271	116	387

REQUIRED - Census Geographic Area Data
Identify the census tract and block group(s) in which the project will take place

Census Tract (6-digit): 1705.00

01	02	03	04	05	06	07	08	09	10
<input type="checkbox"/>	<input type="checkbox"/>	<input type="checkbox"/>	<input checked="" type="checkbox"/>	<input type="checkbox"/>	<input type="checkbox"/>	<input type="checkbox"/>	<input type="checkbox"/>	<input type="checkbox"/>	<input type="checkbox"/>

County Code: 477

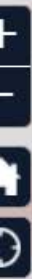

burton texas



Show search results for **burton texas**

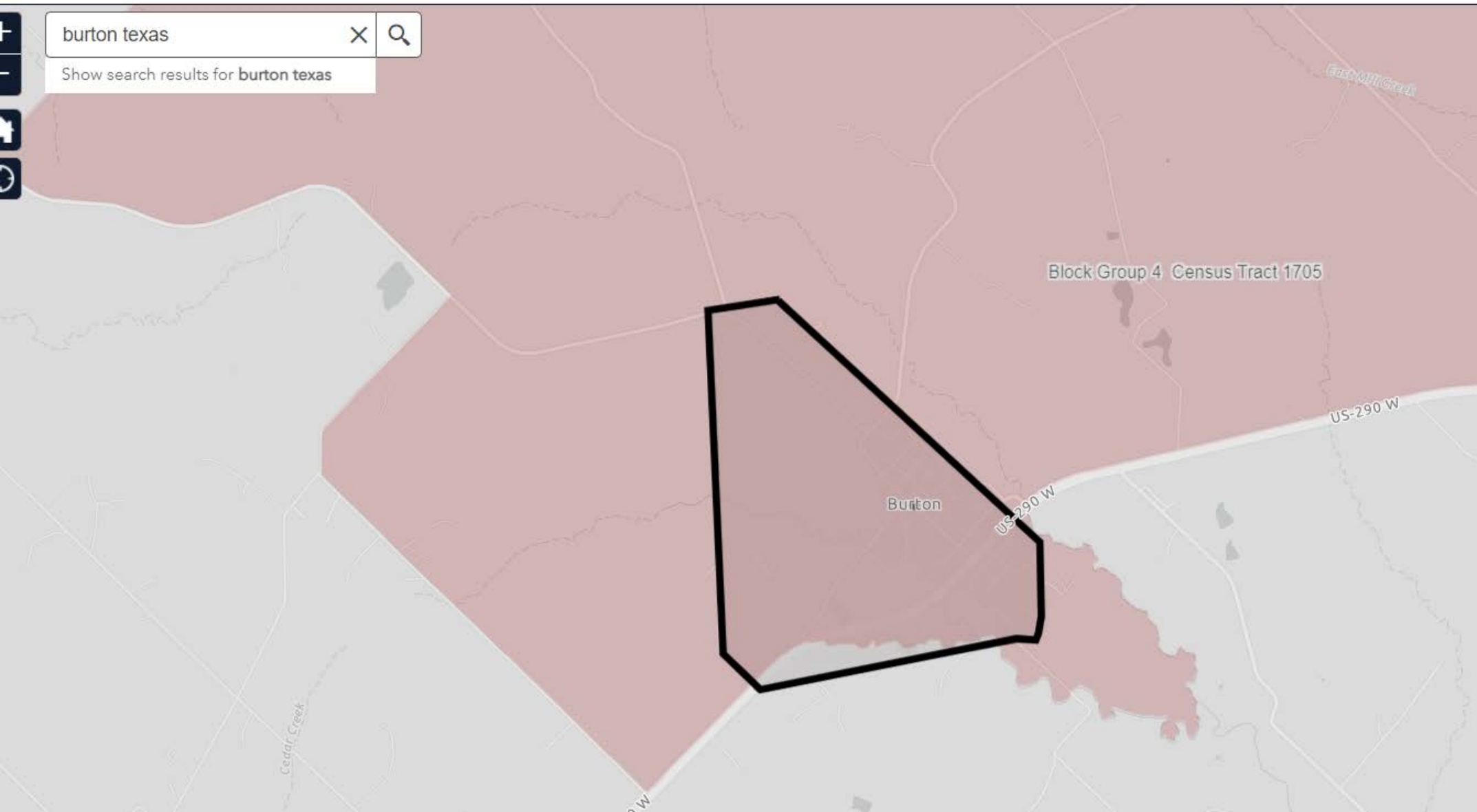



×🔍

Show search results for **burton texas**

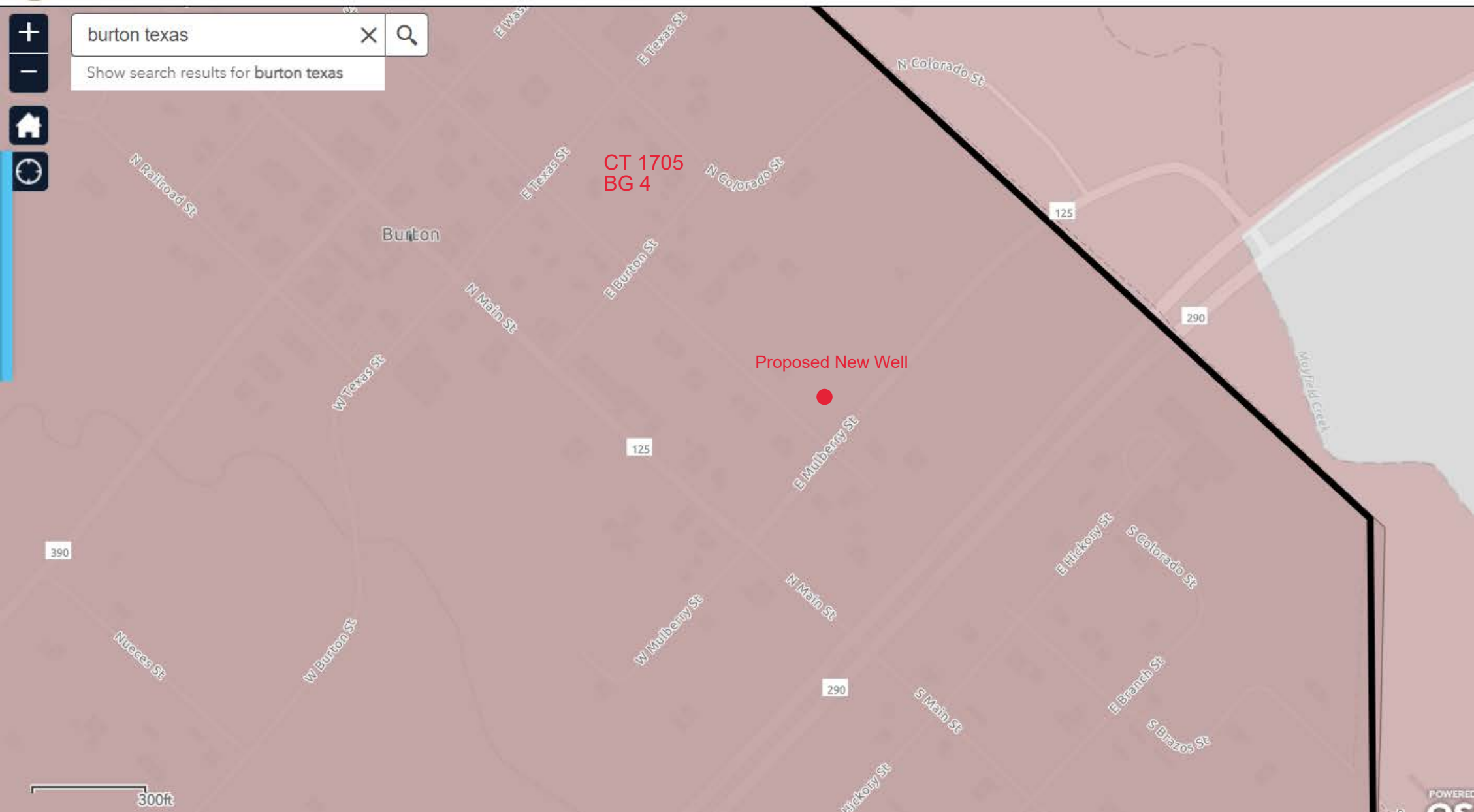

INSTRUCTIONS AND DATA SOURCE		
Data Source: Most Recent ACS 5-year Est. - Table DP05		
City Applicants: Enter city-wide data as reflected on Table DP05		
County Applicants: Enter census tract data as reflected on Table DP05		
APPLICANT:		Burton
Sex and Age	ENTER DP05 DATA HERE	
Male:	435	
Female:	187	
One Race		
White:	435	
Black or African American:	25	
American Indian and Alaska Native:	0	
Asian:	4	
Native Hawaiian and Other Pacific Islander:	0	
Some Other Race:	0	
Two or more races:	4	
-White and Black or African American:	0	
-White and American Indian and Alaska Native:	0	
-White and Asian:	4	
-Black or African American and American Indian and Alaska Native:	0	
Hispanic or Latino and Race		
Hispanic or Latino (of any race):	468	
Not Hispanic or Latino:	458	
-White alone:	425	
-Black or African American alone:	25	
-American Indian and Alaska Native alone:	0	
-Asian alone:	4	
-Native Hawaiian and Other Pacific Islander alone:	0	
-Some other race alone:	0	
-Two or more races:	4	
Enter Number of Project Beneficiaries:		
		387
Gender of Project Beneficiaries		
Male	271	
Female	116	
Race and Ethnicity of Project Beneficiaries	Hispanic	Non-Hispanic
White	8	352
Black/African American	0	21
American Indian/Alaska Native	0	0
Asian	0	3
Native Hawaiian/Other Pacific Islander	0	0
Some Other Race	0	0
White and Black/African American	0	0
White and American Indian/Alaska Native	0	0
White and Asian	0	3
Black/African American and American Indian/Alaska Native	0	0
Other multi racial	0	0
Total:	387	

PLACE	TX	48	Burton city	YES	11536	204	387	52.71%	+/-17.10	+/-9.10
-------	----	----	-------------	-----	-------	-----	-----	--------	----------	---------



City of Burton - Mitigation Viewer Report

Area of Interest (AOI) Information

Length : 4.47 mi

Mar 24 2023 7:50:33 Pacific Daylight Time

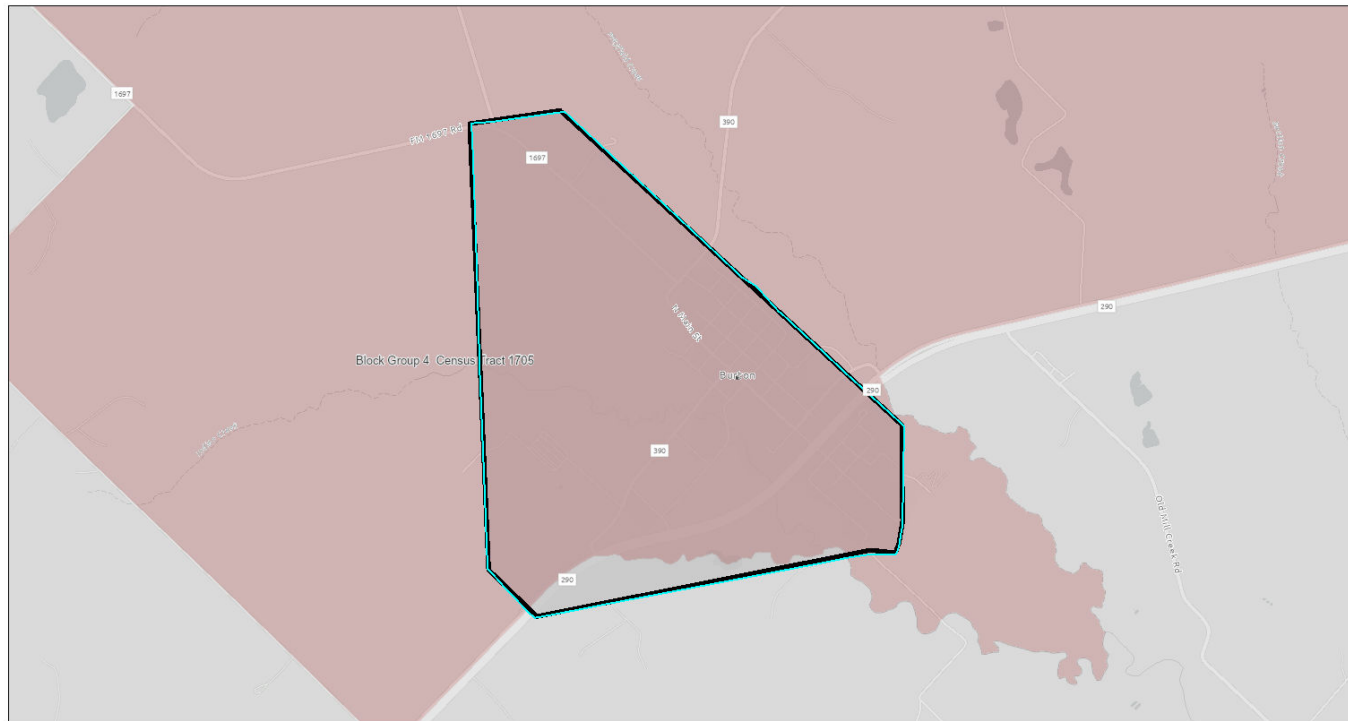

LMI FY2021 by BLOCK GROUP SMI Waiver Applied

Less than 51%	Texas Councils of Governments
51% and Greater	County Boundary
	City and Town (2021)

1:18,056

0 0.17 0.35 0.7 mi

0 0.3 0.6 1.2 km

Esri Community Maps Contributors, Baylor University,
Texas Parks & Wildlife, COMAP, Esri, HERE, Garmin,
SafeGraph, GeoTechnologies, Inc, METNIASA, USGS,
EPA, NPS, US Census Bureau, USDA

Summary

Name	Count	Area(acres)	Length(mi)
Low- and Moderate-Income Population by Block Group (SMI Waiver Applied FY2021)	2	N/A	N/A
Low- and Moderate-Income Population by Place (SMI Waiver Applied FY2021)	1	N/A	N/A
Low- and Moderate-Income Population by County (SMI Waiver Applied FY2021)	1	N/A	N/A
Limited English Proficiency by Block Group (ACS 5YR 2019)	2	N/A	N/A
Population Age 65 and Over by Block Group (ACS 5YR 2019)	2	N/A	N/A
Minority Population by Block Group (ACS 5YR 2019)	2	N/A	N/A
Population with a Disability by Tract (ACS 5YR 2019)	1	N/A	N/A
Population in Poverty by Block Group (ACS 5YR 2019)	2	N/A	N/A
National Origin by Block Group (ACS 5YR 2019)	2	N/A	N/A
Total Population (Male/Female) by Block Group (ACS 5YR 2019)	2	N/A	N/A
Familial Status by Block Group (ACS 5YR 2019)	2	N/A	N/A
Racially or Ethnically Concentrated Areas of Poverty (R/ECAPs) ACS 5YR 2013	0	N/A	N/A
Social Vulnerability Index of CDBG-MIT Counties by Census Tract	1	N/A	N/A

Low- and Moderate-Income Population by Block Group (SMI Waiver Applied FY2021)

#	GEOID	COG:	CDBG MIT:	Qualify for State Median Income Waiver:	Low- and Moderate-Income Population	Low- and Moderate-Income Universe Population	Low- and Moderate-Income Percentage:	Area(acres)
1	484771705004	BVCOG	State MID	YES	484	915	52.9	N/A
2	484771705006	BVCOG	State MID	YES	349	1,384	25.22	N/A

Low- and Moderate-Income Population by Place (SMI Waiver Applied FY2021)

#	GEOID	Place Name:	County Code:	County Name:	CDBG-MIT:	COG:	Qualify for State Median Income Waiver:	Low- and Moderate-Income Population:
1	4811536	Burton city	477	Washington	State MID	BVCOG	YES	204

#	Low- and Moderate-Income Universe Population:	Low- and Moderate-Income Percentage:	Area(acres)
1	387	0.527132	N/A

Low- and Moderate-Income Population by County (SMI Waiver Applied FY2021)

#	County Name:	County Code:	GEOID	COG:	CDBG-MIT:	Qualify for State Median Income Waiver:	Low- and Moderate-Income Population:	Low- and Moderate-Income Universe Population:	Low- and Moderate-Income Percentage:	Area(acres)
1	Washington County	477	48477	BVCOG	State MID	YES	15,433	32,771	47.09	N/A

Limited English Proficiency by Block Group (ACS 5YR 2019)

#	GEOID	NAME	Estimate Total	Estimate Total: 5 to 17 years	Estimate Total: 5 to 17 years: Speak only English	Estimate Total: 5 to 17 years: Speak Spanish	Estimate Total: 5 to 17 years: Speak Spanish: Speak English very well	Estimate Total: 5 to 17 years: Speak Spanish: Speak English well
1	484771705004	Block Group 4, Census Tract 1705, Washington County	846	101	101	0	0	0
2	484771705006	Block Group 6, Census Tract 1705, Washington County	1,341	260	260	0	0	0

#	Estimate Total: 5 to 17 years: Speak Spanish: Speak English not well	Estimate Total: 5 to 17 years: Speak Spanish: Speak English not at all	Estimate Total: 5 to 17 years: Speak other Indo-European languages	Estimate Total: 5 to 17 years: Speak other Indo-European languages: Speak English very well	Estimate Total: 5 to 17 years: Speak other Indo-European languages: Speak English well	Estimate Total: 5 to 17 years: Speak other Indo-European languages: Speak English not well	Estimate Total: 5 to 17 years: Speak other Indo-European languages: Speak English not at all	Estimate Total: 5 to 17 years: Speak Asian and Pacific Island languages
1	0	0	0	0	0	0	0	0
2	0	0	0	0	0	0	0	0

#	Estimate Total: 5 to 17 years: Speak Asian and Pacific Island languages: Speak English very well	Estimate Total: 5 to 17 years: Speak Asian and Pacific Island languages: Speak English well	Estimate Total: 5 to 17 years: Speak Asian and Pacific Island languages: Speak English not well	Estimate Total: 5 to 17 years: Speak Asian and Pacific Island languages: Speak English not at all	Estimate Total: 5 to 17 years: Speak other languages	Estimate Total: 5 to 17 years: Speak other languages: Speak English very well	Estimate Total: 5 to 17 years: Speak other languages: Speak English well	Estimate Total: 5 to 17 years: Speak other languages: Speak English not well
1	0	0	0	0	0	0	0	0
2	0	0	0	0	0	0	0	0

#	Estimate Total: 5 to 17 years: Speak other languages: Speak English not at all	Estimate Total: 18 to 64 years	Estimate Total: 18 to 64 years: Speak only English	Estimate Total: 18 to 64 years: Speak Spanish	Estimate Total: 18 to 64 years: Speak Spanish: Speak English very well	Estimate Total: 18 to 64 years: Speak Spanish: Speak English well	Estimate Total: 18 to 64 years: Speak Spanish: Speak English not well	Estimate Total: 18 to 64 years: Speak Spanish: Speak English not at all
1	0	539	491	35	0	35	0	0
2	0	647	573	74	18	28	0	28

#	Estimate Total: 18 to 64 years: Speak other Indo-European languages	Estimate Total: 18 to 64 years: Speak other Indo-European languages: Speak English very well	Estimate Total: 18 to 64 years: Speak other Indo-European languages: Speak English well	Estimate Total: 18 to 64 years: Speak other Indo-European languages: Speak English not well	Estimate Total: 18 to 64 years: Speak other Indo-European languages: Speak English not at all	Estimate Total: 18 to 64 years: Speak Asian and Pacific Island languages	Estimate Total: 18 to 64 years: Speak Asian and Pacific Island languages: Speak English very well	Estimate Total: 18 to 64 years: Speak Asian and Pacific Island languages: Speak English well
1	0	0	0	0	0	13	11	0
2	0	0	0	0	0	0	0	0

#	Estimate Total: 18 to 64 years: Speak Asian and Pacific Island languages: Speak English not well	Estimate Total: 18 to 64 years: Speak Asian and Pacific Island languages: Speak English not at all	Estimate Total: 18 to 64 years: Speak other languages	Estimate Total: 18 to 64 years: Speak other languages: Speak English very well	Estimate Total: 18 to 64 years: Speak other languages: Speak English well	Estimate Total: 18 to 64 years: Speak other languages: Speak English not well	Estimate Total: 18 to 64 years: Speak other languages: Speak English not at all	Estimate Total: 65 years and over
1	2	0	0	0	0	0	0	206
2	0	0	0	0	0	0	0	434

#	Estimate Total: 65 years and over: Speak only English	Estimate Total: 65 years and over: Speak Spanish	Estimate Total: 65 years and over: Speak Spanish: Speak English very well	Estimate Total: 65 years and over: Speak Spanish: Speak English well	Estimate Total: 65 years and over: Speak Spanish: Speak English not well	Estimate Total: 65 years and over: Speak Spanish: Speak English not at all	Estimate Total: 65 years and over: Speak other Indo-European languages	Estimate Total: 65 years and over: Speak other Indo-European languages: Speak English very well
1	184	13	0	0	13	0	9	9
2	434	0	0	0	0	0	0	0

#	Estimate Total: 65 years and over: Speak other Indo-European languages: Speak English well	Estimate Total: 65 years and over: Speak other Indo-European languages: Speak English not well	Estimate Total: 65 years and over: Speak other Indo-European languages: Speak English not at all	Estimate Total: 65 years and over: Speak Asian and Pacific Island languages	Estimate Total: 65 years and over: Speak Asian and Pacific Island languages: Speak English very well	Estimate Total: 65 years and over: Speak Asian and Pacific Island languages: Speak English well	Estimate Total: 65 years and over: Speak Asian and Pacific Island languages: Speak English not well	Estimate Total: 65 years and over: Speak Asian and Pacific Island languages: Speak English not at all
1	0	0	0	0	0	0	0	0
2	0	0	0	0	0	0	0	0

#	Estimate Total: 65 years and over: Speak other languages	Estimate Total: 65 years and over: Speak other languages: Speak English very well	Estimate Total: 65 years and over: Speak other languages: Speak English well	Estimate Total: 65 years and over: Speak other languages: Speak English not well	Estimate Total: 65 years and over: Speak other languages: Speak English not at all	Estimate Total: Speak English Less than very well	Percent Speak English Less than very well	Area(acres)
1	0	0	0	0	0	50	5.91	N/A
2	0	0	0	0	0	56	4.18	N/A

Population Age 65 and Over by Block Group (ACS 5YR 2019)

#	GEOID	NAME	Estimate Total	Estimate Total: 65 and over	Percent Total: 65 and over	Area(acres)
1	484771705004	Block Group 4, Census Tract 1705, Washington County	914	206	22.54	N/A
2	484771705006	Block Group 6, Census Tract 1705, Washington County	1,382	434	31.40	N/A

Minority Population by Block Group (ACS 5YR 2019)

#	GEOID	NAME	Total Population	Estimate Total: Not Hispanic or Latino	Estimate Total: Not Hispanic or Latino: White alone	Estimate Total: Not Hispanic or Latino: Black or African American alone	Estimate Total: Not Hispanic or Latino: American Indian and Alaska Native alone	Estimate Total: Not Hispanic or Latino: Asian alone
1	484771705004	Block Group 4, Census Tract 1705, Washington County	914	866	724	131	0	4
2	484771705006	Block Group 6, Census Tract 1705, Washington County	1,382	1,326	1,326	0	0	0

#	Estimate Total: Not Hispanic or Latino: Native Hawaiian and Other Pacific Islander alone	Estimate Total: Not Hispanic or Latino: Some other race alone	Estimate Total: Not Hispanic or Latino: Two or more races	Estimate Total: Not Hispanic or Latino: Two or more races: Two races including Some other race	Estimate Total: Not Hispanic or Latino: Two or more races: Two races excluding Some other race, and three or more races	Estimate Total: Hispanic or Latino	Estimate Total: Hispanic or Latino: White alone	Estimate Total: Hispanic or Latino: Black or African American alone
1	0	0	7	0	7	48	10	0
2	0	0	0	0	0	56	56	0

#	Estimate Total: Hispanic or Latino: American Indian and Alaska Native alone	Estimate Total: Hispanic or Latino: Asian alone	Estimate Total: Hispanic or Latino: Native Hawaiian and Other Pacific Islander alone	Estimate Total: Hispanic or Latino: Some other race alone	Estimate Total: Hispanic or Latino: Two or more races	Estimate Total: Hispanic or Latino: Two or more races: Two races including Some other race	Estimate Total: Hispanic or Latino: Two or more races: Two races excluding Some other race, and three or more races	Estimate Total: Minority	Percent Minority	Area(acres)
1	0	0	0	38	0	0	0	190	20.79	N/A
2	0	0	0	0	0	0	0	56	4.05	N/A

Population with a Disability by Tract (ACS 5YR 2019)

#	GEOID	Geographic Area Name	Total Civilian Noninstitutionalized Population	Total Civilian Noninstitutionalized Population With a disability	Percent of Civilian Noninstitutionalized Population With a disability	Area(acres)
1	48477170500	Census Tract 1705, Washington County, Texas	6,842	1,239	18.11	N/A

Population in Poverty by Block Group (ACS 5YR 2019)

#	GEOID	NAME	Total Population for whom poverty status is determined	Total Population with income in past 12 month below poverty level	Percent Population in Poverty	Area(acres)
1	484771705004	Block Group 4, Census Tract 1705, Washington County	914	109	11.93	N/A
2	484771705006	Block Group 6, Census Tract 1705, Washington County	1,382	0	0.00	N/A

National Origin by Block Group (ACS 5YR 2019)

#	GEOID	NAME	Estimate Total	Estimate Total: Native	Estimate Total: Foreign born	Native Born Percent	Foreign Percent	Area(acres)
1	484771705004	Block Group 4, Census Tract 1705, Washington County	914	872	42	95.40	4.60	N/A
2	484771705006	Block Group 6, Census Tract 1705, Washington County	1,382	1,311	71	94.86	5.14	N/A

Total Population (Male/Female) by Block Group (ACS 5YR 2019)

#	GEOID	NAME	Estimate Total	Estimate Total: Male	Estimate Total: Female	Percent Female	Percent Male	Area(acres)
1	484771705004	Block Group 4, Census Tract 1705, Washington County	914	424	490	53.61	46.39	N/A
2	484771705006	Block Group 6, Census Tract 1705, Washington County	1,382	690	692	50.07	49.93	N/A

Familial Status by Block Group (ACS 5YR 2019)

#	Estimate Total	Estimate Total: Married-couple household	Estimate Total: Married-couple household: With children of the householder under 18 years	Estimate Total: Married-couple household: With no children of the householder under 18 years	Estimate Total: Cohabiting couple household	Estimate Total: Cohabiting couple household: With children of the householder under 18 years	Estimate Total: Cohabiting couple household: With no children of the householder under 18 years	Estimate Total: Female householder, no spouse or partner present
1	460	185	42	143	16	11	5	120
2	635	459	122	337	0	0	0	136

#	Estimate Total: Female householder, no spouse or partner present: Living alone	Estimate Total: Female householder, no spouse or partner present: With children of the householder under 18 years	Estimate Total: Female householder, no spouse or partner present: With relatives, no children of the householder under 18 years	Estimate Total: Female householder, no spouse or partner present: With only nonrelatives present	Estimate Total: Male householder, no spouse or partner present	Estimate Total: Male householder, no spouse or partner present: Living alone	Estimate Total: Male householder, no spouse or partner present: With children of the householder under 18 years	Estimate Total: Male householder, no spouse or partner present: With relatives, no children of the householder under 18 years	Estimate Total: Male householder, no spouse or partner present: With only nonrelatives present	Area(acres)
1	92	4	24	0	139	137	0	2	0	N/A
2	124	0	12	0	40	40	0	0	0	N/A

Social Vulnerability Index of CDBG-MIT Counties by Census Tract

#	GEOID	County Name	Geographic Area Name	Social Vulnerability Index Class Number of CDBG-MIT Counties by Census Tract	Social Vulnerability Index Class of CDBG-MIT Counties by Census Tract	COG	Council of Government	Area(acres)
1	48477170500	Washington County	Census Tract 1705	3	Medium	BVCOG	Brazos Valley Council of Governments	N/A