

# WINDMERE TOWNSHIP ROADS

# 49.479 MILES

## TOWNSHIP OF WINDMERE

PREPARED BY THE  
MINNESOTA DEPARTMENT OF TRANSPORTATION  
OFFICE OF TRANSPORTATION SYSTEM MANAGEMENT

IN COOPERATION WITH  
U.S. DEPARTMENT OF TRANSPORTATION  
FEDERAL HIGHWAY ADMINISTRATION

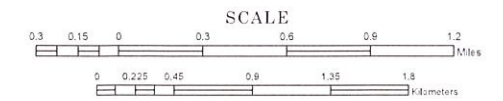

1 in = 1,600 ft



Projection:  
Transverse Mercator  
NAD 1983  
UTM Zone 15

North American Datum  
of 1983

ROAD AND HIGHWAY FEATURES		PUBLIC SERVICE FEATURES	
INTERSTATE HIGHWAY		WOOD OFFICE	
UNITED STATES HIGHWAY		WOOD TRUCK STATION	
MINNESOTA STATE HIGHWAY		HIGHWAY PARKS DEPARTMENT OFFICE	
COUNTY STATE AID HIGHWAY		STATE TRAVEL INFORMATION CENTER	
COUNTY ROAD		REST AREA (FULL SERVICE)	
MUNICIPAL STATE AID STREET		REST AREA (QUARTER SERVICE)	
MUNICIPAL STREET		WARRIORS VAULT OR P-TOILET	
PRIVATE STREET/ROAD		LOCAL PARK	
TOWNSHIP ROAD		PUBLIC ACCESS POINT	
UNORGANIZED TERRITORY ROAD		FAIRGROUNDS	
INDIAN SERVICE ROAD		PORT OF ENTRY	
RAVINE OR CONVECTOR		PARK AND RIDE LOT	
INTERSTATE EMP.		PUBLIC UNIVERSITY OR COLLEGE	
GREAT RIVER ROAD		TOWN HALL	
OTHER ROADS		ARMORY	
NATURAL PARK		CULTURAL FEATURES	
NATURAL FOREST		STATE HISTORICAL MONUMENT	
SAND PIT		HISTORIC DISTRICT	
MOUND		HISTORIC SITE	
OTHER MONUMENT		MUNICIPALITY	
ADJACENT WATERWAY		ADJACENT WATERWAY	
FEDERAL ADJUSTED URBAN AREA ZONAL		MILEAGE	
UNIVERSITY NATIONAL PARK		UNIVERSITY NATIONAL PARK	
30-JANUARY WATER RESOURCES SERVICE		STATE PARK	
STATE PARK		REGIONAL PARK	
REGIONAL PARK		NATIONAL FOREST	
NATIONAL FOREST		NATIONAL AND STATE FOREST	
NATIONAL AND STATE FOREST		STATE FOREST	
STATE FOREST		NATIONAL TRAIL	
NATIONAL TRAIL		WILDLIFE REFUGES	
WILDLIFE REFUGES		WILDLIFE MANAGEMENT AREA	
WILDLIFE MANAGEMENT AREA		HIDROLOGIC FEATURES	
HIDROLOGIC FEATURES		BEVER OR STREAM DEVIATION	
BEVER OR STREAM DEVIATION		LAKE, POND OR RESERVOIR	
LAKE, POND OR RESERVOIR		STREAM OR RIVER	
STREAM OR RIVER		WETLAND	
WETLAND		BEAUS OR LANDS	
BEAUS OR LANDS		REGIONAL WATERSHED	
REGIONAL WATERSHED			

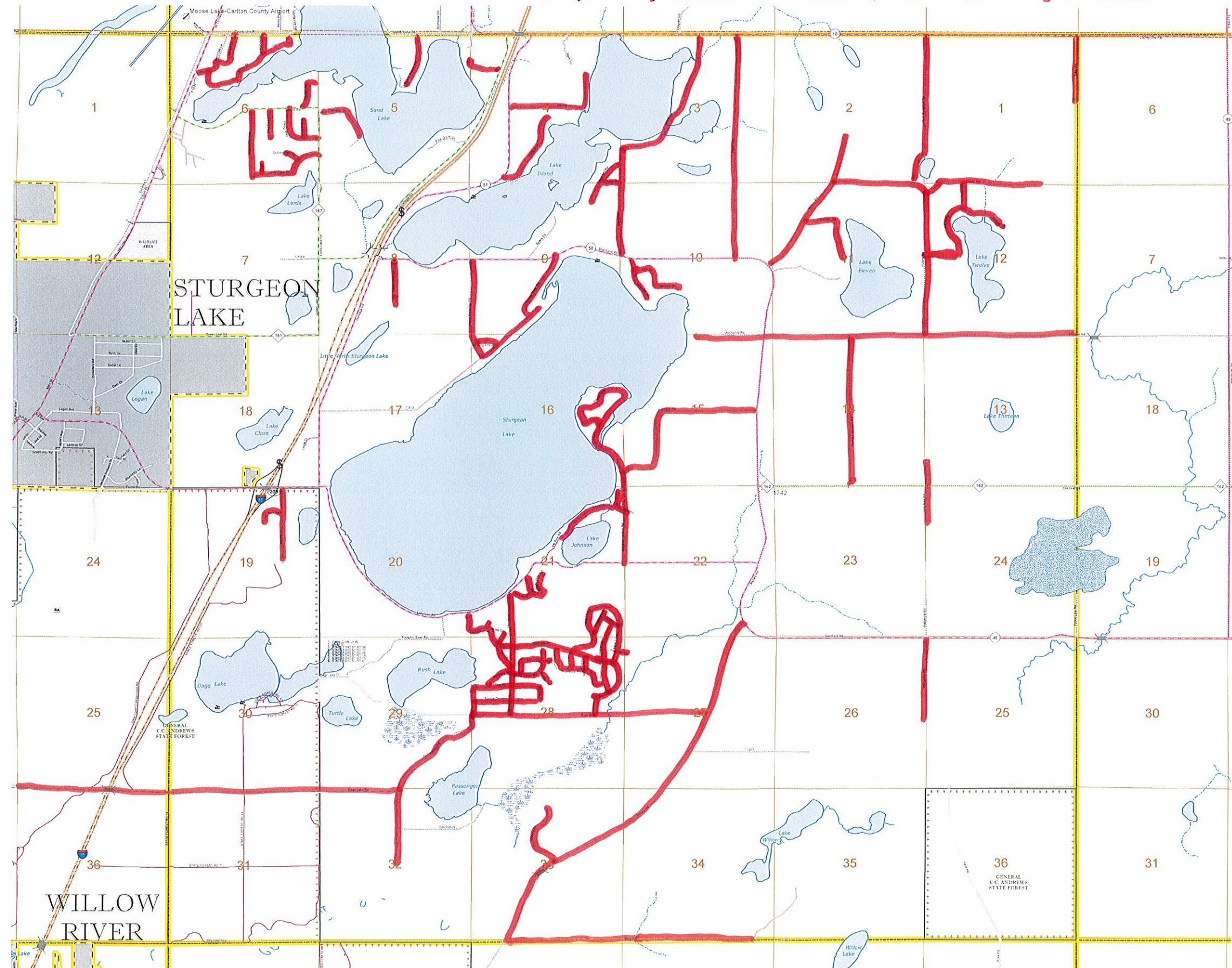

Population (U.S. Census 2010): 1711

To request information from this document in an alternative format, call 651-366-4718 or 1-800-657-3774 (Greater Minnesota), 711 or 1-800-627-3529 (Minnesota Relay). You may also send an e-mail to ADRequest.dot@state.mn.us. (Please request at least one week in advance.)

# Windemere Township Roads

#	Route	Section(s)	Name	Miles	Type	Dead End
1	T-65	15 - 16	Sturgeon Island Road	1.000	Asphalt	No
2	T-629	33	Ring Road	2.000	Gravel	Yes
3	T-634	21, 28, 29, 30	Dago Lake Road	3.000	Asphalt	No
4	T-651	15	Hill Street Road	1.300	Gravel	No
5	T-652	21	Laura Lane	0.250	Gravel	Yes
6	T-654	27, 28, 29	Rush Blvd	2.800	Gravel	No
7	T-748	19	Warbler Lane	0.100	Asphalt	Yes
7	T-748	19	Warbler Lane	0.200	Gravel	Yes
8	T-756	29, 32	Dobosenski Road	1.910	Gravel	Yes
9	T-758	8, 9	Moss Lane	0.720	Gravel	No
10	T-761	3, 4	Island Lake Road	1.770	Asphalt	No
11	T-763	27, 33, 34	Military Road South	2.630	Gravel	No
12	T-770	3, 10	Palon Road	1.490	Asphalt	No
13	T-772	1, 2	Partridge Road North	1.000	Gravel	No
14	T-774	14	Northridge Road	1.000	Gravel	No
15	T-782	12	Lake Twelve Road	1.200	Gravel	No
16	T-828	9	Brandt Road	0.510	Gravel	No
17	T-878	21	Sunset Bay Road	0.100	Gravel	Yes
18	T-881	12	Balsam Road	0.170	Gravel	Yes
19	T-882	4	Twilight Lane	0.630	Asphalt	Yes
20	T-883	4	Warloe Road	0.400	Asphalt	Yes
21	T-902	6	Chestnut Circle	0.750	Asphalt	No
22	T-903	6	Hemlock Lane	0.150	Gravel	No
23	A	4, 5	Lakeshore Drive	0.250	Gravel	Yes
24	B	5	Sunny Beach Road	0.450	Asphalt	Yes
25	D	6	Sunset Lane	0.500	Gravel	Yes
26	E	6	Viking Way	0.450	Asphalt	No
27	F	6	Runestone Lane	0.200	Asphalt	Yes
28	G	6	Paulus Road	0.200	Gravel	Yes
29	H	8	Camp Farm Lane	0.300	Gravel	Yes
30	I	9	Sunrise View Road	0.100	Gravel	Yes
31	J	10	Marview Drive	0.150	Gravel	Yes
32		13, 14	Elm Tree Road South	0.300	Gravel	Yes
33		23, 24	Elm Tree Road North	0.500	Gravel	Yes
34		6	Windemere Way	0.500	Asphalt	No
35		6	Pine Tree Lane	0.200	Asphalt	Yes
36		9	Poplar lane	0.100	Gravel	No
37		9	Missing link	0.150	Gravel	No

**Subtotal Sheet 1    29.430**

# Windemere Township Roads

#	Route	Section(s)	Name	Miles	Type	Dead End
38	K	10	Lakeview Lane	0.450	Gravel	Yes
39	L	10	Cliff Drive	0.380	Gravel	Yes
40	M	11	Heppner Road	0.480	Gravel	Yes
41	N	11, 12	Partridge Road South	1.000	Gravel	No
42	O	16, 21, 22	Sturgeon Island Loop	0.800	Asphalt	No
43	P	21	Marina Beach Drive	0.600	Gravel	Yes
44	Q	21	Victoria Place	0.100	Gravel	Yes
45	T	28	Anchorage Place	0.500	Gravel	No
46	U	28	Valdez Circle	0.100	Gravel	Yes
47	V	28	Cori Lane	0.290	Gravel	No
48	W	28	North Star Drive	1.450	Asphalt	No
49	X	28	Devil's Elbow Road	0.550	Gravel	No
50	Z	28	Pinewood Loop	0.200	Gravel	No
51	AA	28	Woodland Place	0.060	Gravel	Yes
52	BB	28	Fern Lane	0.100	Gravel	No
53	CC	28	Northstar Lane	0.190	Gravel	No
54	DD	28	Teal Drive	0.440	Gravel	No
55	EE	28	Spruce Drive East	0.400	Gravel	No
56	EE	28	Spruce Drive West	0.200	Gravel	No
57	FF	28	Thornbury Lane	0.530	Gravel	No
58	GG	28	Alder Loop	0.980	Gravel	No
59	HH	28	Geneva Road	0.080	Gravel	No
60	II	28	Woodstock Road	0.180	Gravel	No
61	JJ	28	Sheridan Road	0.120	Gravel	No
62	KK	28	Frontier Lane	0.450	Gravel	No
63	LL	28	Hawthorne Court	0.040	Gravel	Yes
64	MM	25, 26	Wetherville Road	0.600	Gravel	Yes
65	NN	10, 15	West Pioneer Road	0.600	Gravel	Yes
66	OO	1, 2, 11, 12	Birchview Road	1.450	Gravel	Yes
67	QQ	11, 12, 13, 14	East Pioneer Road	2.100	Gravel	No
68	RR	6	Lords Drive	0.500	Gravel	No
69	SS	4	Evergreen Road	0.400	Gravel	Yes
70	TT	33	Jackpine Lane	0.600	Gravel	Yes
71	UU	2, 11	Military Road North	1.000	Gravel	No
72	VV	19	Majestic Pine Drive	0.400	Asphalt	Yes
73		6	Settlers Court	0.019	Gravel	Yes
74		6	Settlers Pond Drive	0.100	Gravel	Yes
75		21	Arrow Wood Court	0.010	Gravel	Yes
76		21	Harmony Lane	0.800	Asphalt	No
77		21	Mulberry Lane	0.100	Gravel	No
78		1	Telker Road	0.300	Gravel	Yes
79		5	Parkview Road	0.400	Asphalt	Yes

<b>Subtotal Sheet 2</b>	<b>20.049</b>
<b>Subtotal Sheet 1</b>	<b>29.430</b>
<b>Total 49.479</b>	

<b># of Asphalt Roads</b>	<b>18</b>	<b>Miles of Asphalt Roads</b>	<b>14.790</b>
<b># of Gravel Roads</b>	<b>61</b>	<b>Miles of Gravel Roads</b>	<b>34.689</b>

# WINDMERE TOWNSHIP ASPHALT ROADS

14.79 MILES TOTAL

## TOWNSHIP OF WINDMERE

PREPARED BY THE  
MINNESOTA DEPARTMENT OF TRANSPORTATION  
OFFICE OF TRANSPORTATION SYSTEM MANAGEMENT

IN COOPERATION WITH  
U.S. DEPARTMENT OF TRANSPORTATION  
FEDERAL HIGHWAY ADMINISTRATION

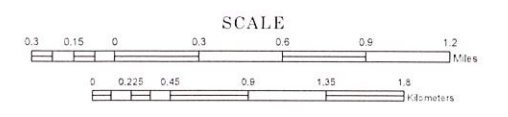

ROAD AND ROADWAY FEATURES	PUBLIC SERVICE FEATURES
INTERSTATE HIGHWAY	WOOD TRUCK STATION
UNITED STATES HIGHWAY	HIGHWAY TRAIL, DISTRICT OFFICE
MINNESOTA TRUNK HIGHWAY	STATE TRAVEL INFORMATION CENTER
COUNTY STATE AID HIGHWAY	REST AREA (ALL SERVICES)
COUNTY ROAD	REST AREA (SNOW TOWNS)
MUNICIPAL STATE AID STREET	WARRIOR VALLEY (PT) TRAILS
MUNICIPAL STREET	LOCAL PARK
PRIVATE STREET/ROAD	PUBLIC ACCESS POINT
TOWNSHIP ROAD	PARADEGROUND
UNORGANIZED TERRITORY ROAD	PORT OF ENTRY
NOBEN SERVICE ROAD	PARKING RIDE LOT
RAMP OR CONNECTOR	PUBLIC UNIVERSITY OR COLLEGE
INTERSTATE EXCH.	TOWN HALL
GREAT NEBEN ROAD	ARMORY
OTHER ROADS	CULTURAL FEATURES
Asphalt Paved	STATE HISTORICAL MARKER
Gravel	HISTORIC DISTRICT
Gravel/Asphalt	HISTORIC SITE
Other	MONUMENT
UNPAVED	BOUNDARY FEATURES
	RES. LAND
	COUNTY
	MUNICIPALITY
	ADJACENT MUNICIPALITY
	FEDERAL ADJUSTED URBAN AREA (2014)
	MILITARY
	VOYAGEUR NATIONAL PARK
	BOUNDARY WATERS CANOE AREA (W. DENVER)
	STATE PARK
	REGIONAL PARK
	NATIONAL FOREST
	NATIONAL AND STATE FOREST
	STATE FOREST
	NATIONAL TRAIL
	WILDLIFE REFUGE AREA
	WILDLIFE MANAGEMENT AREA
	FEED OR STRAY FEEDING
	LAKE, POND OR RESERVOIR
	STREAM OR RIBBONWAY
	DRY CREEK BED
	WETLAND
	BLAND OR LAND
	REGIONAL WATER RIGHT



Population (U.S. Census 2010): 1711

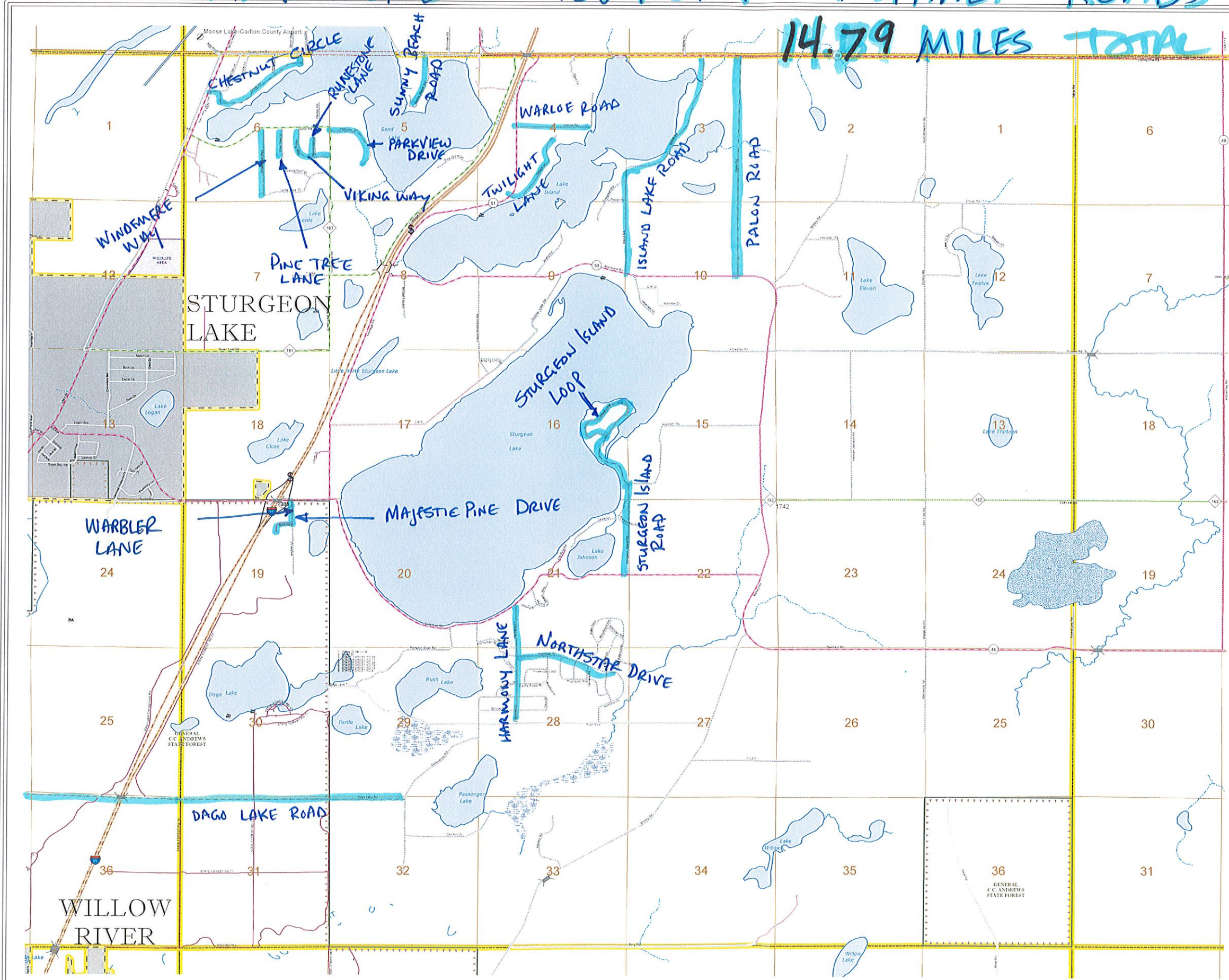

To request information from this document in an alternative format, call 651-366-4718 or 1-800-657-3774 (Greater Minnesota), 711 or 1-800-627-3529 (Minnesota Relay). You may also send an e-mail to ADRequest.dot@state.mn.us. (Please request at least one week in advance.)

# ASPHALT

## Windemere Township Roads

#	Route	Section(s)	Name	Miles	Type	Dead End
1	T-65	15 - 16	Sturgeon Island Road	1.000	Asphalt	No
2	T-629	33	Ring Road	2.000	Gravel	Yes
3	T-634	21, 28, 29, 30	Dago Lake Road	3.000	Asphalt	No
4	T-651	15	Hill Street Road	1.300	Gravel	No
5	T-652	21	Laura Lane	0.250	Gravel	Yes
6	T-654	27, 28, 29	Rush Blvd	2.800	Gravel	No
7	T-748	19	Warbler Lane	0.100	Asphalt	Yes
7	T-748	19	Warbler Lane	0.200	Gravel	Yes
8	T-756	29, 32	Dobosenski Road	1.910	Gravel	Yes
9	T-758	8, 9	Moss Lane	0.720	Gravel	No
10	T-761	3, 4	Island Lake Road	1.770	Asphalt	No
11	T-763	27, 33, 34	Military Road South	2.630	Gravel	No
12	T-770	3, 10	Palon Road	1.490	Asphalt	No
13	T-772	1, 2	Partridge Road North	1.000	Gravel	No
14	T-774	14	Northridge Road	1.000	Gravel	No
15	T-782	12	Lake Twelve Road	1.200	Gravel	No
16	T-828	9	Brandt Road	0.510	Gravel	No
17	T-878	21	Sunset Bay Road	0.100	Gravel	Yes
18	T-881	12	Balsam Road	0.170	Gravel	Yes
19	T-882	4	Twilight Lane	0.630	Asphalt	Yes
20	T-883	4	Warloe Road	0.400	Asphalt	Yes
21	T-902	6	Chestnut Circle	0.760	Asphalt	No
22	T-903	6	Hemlock Lane	0.150	Gravel	No
23	A	4, 5	Lakeshore Drive	0.250	Gravel	Yes
24	B	5	Sunny Beach Road	0.450	Asphalt	Yes
25	D	6	Sunset Lane	0.500	Gravel	Yes
26	E	8	Viking Way	0.450	Asphalt	No
27	F	6	Runestone Lane	0.200	Asphalt	Yes
28	G	6	Paulus Road	0.200	Gravel	Yes
29	H	8	Camp Farm Lane	0.300	Gravel	Yes
30	I	9	Sunrise View Road	0.100	Gravel	Yes
31	J	10	Marview Drive	0.150	Gravel	Yes
32		13, 14	Elm Tree Road South	0.300	Gravel	Yes
33		23, 24	Elm Tree Road North	0.500	Gravel	Yes
34		6	Windemere Way	0.500	Asphalt	No
35		8	Pine Tree Lane	0.200	Asphalt	Yes
36		9	Poplar lane	0.100	Gravel	No
37		9	Missing link	0.150	Gravel	No

**Subtotal Sheet 1 29.430**

# ASPHALT

## Windemere Township Roads

#	Route	Section(s)	Name	Miles	Type	Dead End
38	K	10	Lakeview Lane	0.450	Gravel	Yes
39	L	10	Cliff Drive	0.380	Gravel	Yes
40	M	11	Heppner Road	0.480	Gravel	Yes
41	N	11, 12	Partridge Road South	1.000	Gravel	No
42	O	16, 21, 22	Sturgeon Island Loop	0.800	Asphalt	No
43	P	21	Marina Beach Drive	0.600	Gravel	Yes
44	Q	21	Victoria Place	0.100	Gravel	Yes
45	T	28	Anchorage Place	0.500	Gravel	No
46	U	28	Valdez Circle	0.100	Gravel	Yes
47	V	28	Cori Lane	0.290	Gravel	No
48	W	28	North Star Drive	1.450	Asphalt	No
49	X	28	Devil's Elbow Road	0.550	Gravel	No
50	Z	28	Pinewood Loop	0.200	Gravel	No
51	AA	28	Woodland Place	0.060	Gravel	Yes
52	BB	28	Fern Lane	0.100	Gravel	No
53	CC	28	Northstar Lane	0.190	Gravel	No
54	DD	28	Teal Drive	0.440	Gravel	No
55	EE	28	Spruce Drive East	0.400	Gravel	No
56	EE	28	Spruce Drive West	0.200	Gravel	No
57	FF	28	Thornbury Lane	0.530	Gravel	No
58	GG	28	Alder Loop	0.980	Gravel	No
59	HH	28	Geneva Road	0.080	Gravel	No
60	II	28	Woodstock Road	0.180	Gravel	No
61	JJ	28	Sheridan Road	0.120	Gravel	No
62	KK	28	Frontier Lane	0.450	Gravel	No
63	LL	28	Hawthorne Court	0.040	Gravel	Yes
64	MM	25, 26	Wetherville Road	0.600	Gravel	Yes
65	NN	10, 15	West Pioneer Road	0.600	Gravel	Yes
66	OO	1, 2, 11, 12	Birchview Road	1.450	Gravel	Yes
67	QQ	11, 12, 13, 14	East Pioneer Road	2.100	Gravel	No
68	RR	6	Lords Drive	0.500	Gravel	No
69	SS	4	Evergreen Road	0.400	Gravel	Yes
70	TT	33	Jackpine Lane	0.600	Gravel	Yes
71	UU	2, 11	Military Road North	1.000	Gravel	No
72	VV	19	Majestic Pine Drive	0.400	Asphalt	Yes
73		6	Settlers Court	0.019	Gravel	Yes
74		6	Settlers Pond Drive	0.100	Gravel	Yes
75		21	Arrow Wood Court	0.010	Gravel	Yes
76		21	Harmony Lane	0.800	Asphalt	No
77		21	Mulberry Lane	0.100	Gravel	No
78		1	Telker Road	0.300	Gravel	Yes
79		5	Parkview Road	0.400	Asphalt	Yes

**Subtotal Sheet 2 20.049**

**Subtotal Sheet 1 29.430**

**Total 49.479**

**# of Asphalt Roads 18 Miles of Asphalt Roads 14.790**

**# of Gravel Roads 61 Miles of Gravel Roads 34.689**

# WILD ACRES ROADS

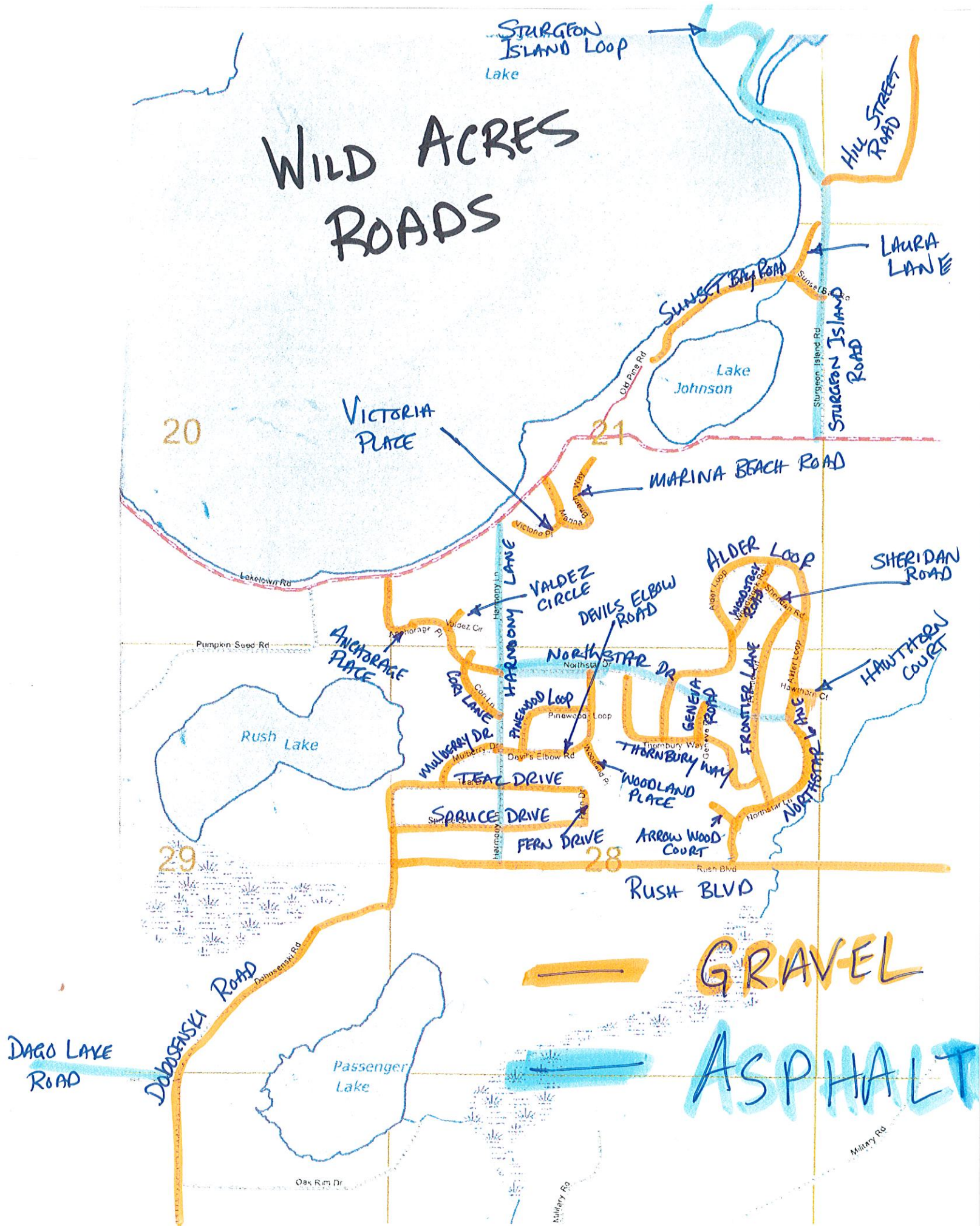

# WINDMERE TOWNSHIP GRAVEL ROADS 34.689 MILES

## TOWNSHIP OF WINDMERE

PREPARED BY THE  
MINNESOTA DEPARTMENT OF TRANSPORTATION  
OFFICE OF TRANSPORTATION SYSTEM MANAGEMENT

IN COOPERATION WITH  
U.S. DEPARTMENT OF TRANSPORTATION  
FEDERAL HIGHWAY ADMINISTRATION

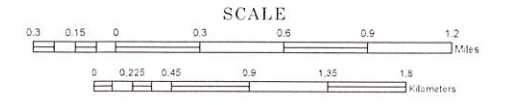

ROAD AND ROADWAY FEATURES	PUBLIC SERVICE FEATURES
INTERSTATE	WOOD OFFICE
UNITED STATES HIGHWAY	WOOD TRUCK STATION
MINNESOTA TRUNK HIGHWAY	HIGHWAY PAVEMENT DISTRICT OFFICE
COUNTY STATE ROAD	STATE TRUCK INFORMATION CENTER
MUNICIPAL STATE STREET	REST AREA (NORTH/SOUTH)
PRIVATE STREET/ROAD	REST AREA (SOUTH/NORTH)
TOWNSHIP ROAD	WAPLES DRIVE (SOUTH/NORTH)
UNDESIGNATED TERRITORY ROAD	LOCAL PARK
INDIA SERVICE ROAD	PUBLIC ACCESS POINT
RAMP OR CONNECTOR	PARKING LOT
INTERSTATE EXCH	PUBLIC UNIVERSITY OR COLLEGE
GREAT RIVER ROAD	TOWN HALL
OTHER ROAD	ARMORY
Norfolk Park	CULTURAL FEATURES
Arroyo	STATE HISTORICAL MARKER
Chaparral	HISTORIC DISTRICT
Cholla	HISTORIC SITE
Cholla	MONUMENT
Cholla	BOUNDARY FEATURES
Cholla	TRAIL LAND
Cholla	COUNTY
Cholla	MUNICIPALITY
Cholla	ADJACENT MUNICIPALITY
Cholla	FEDERAL ADJUSTED LANS AREA (2011)
Cholla	MILITARY
Cholla	INDIGENOUS NATIONAL PARK
Cholla	BOLANDER WATER CHANGING SERVICES
Cholla	STATE PARK
Cholla	REGIONAL PARK
Cholla	NATIONAL FOREST
Cholla	NATIONAL AND STATE FOREST
Cholla	STATE FOREST
Cholla	NATIONAL TRAIL
Cholla	PRIVATE REFUGER AREA
Cholla	WILDLIFE MANAGEMENT AREA
Cholla	RIVER OR STREAM (PREFERRED)
Cholla	LAKE, POND OR RESERVOIR
Cholla	STREAM (PREFERRED)
Cholla	DRYLAND
Cholla	WETLAND
Cholla	BLAND OF LAND
Cholla	REGIONAL WATERBODIES



Population (U.S. Census 2010): 1711

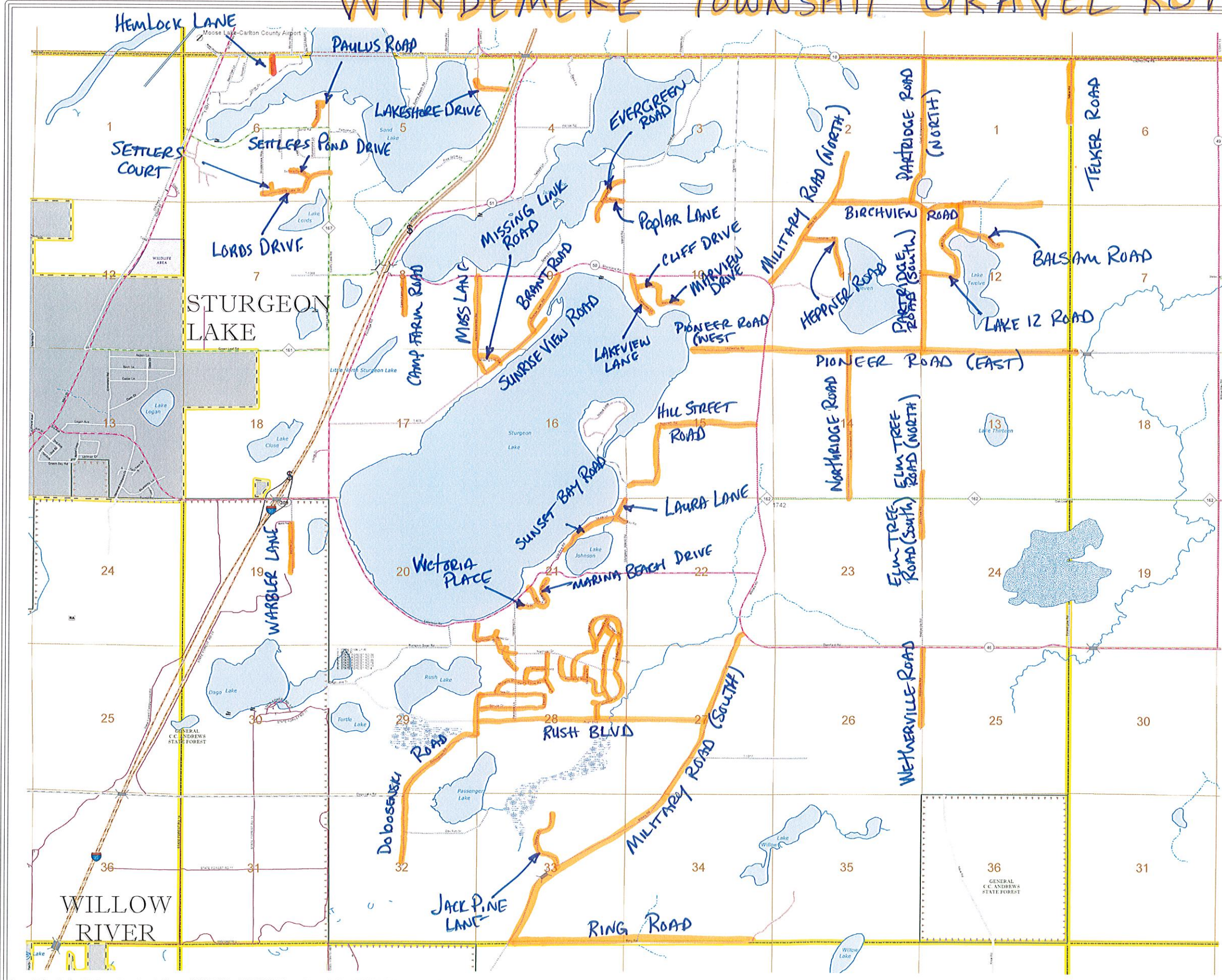

To request information from this document in an alternative format, call 651-366-4718 or 1-800-657-3774 (Greater Minnesota), 711 or 1-800-627-3529 (Minnesota Relay). You may also send an e-mail to ADRequest.dot@state.mn.us. (Please request at least one week in advance.)

# GRAVEL

## Windemere Township Roads

Page 1 of 2

#	Route	Section(s)	Name	Miles	Type	Dead End
1	T-65	15 - 16	Sturgeon Island Road	1.000	Asphalt	No
2	T-629	33	Ring Road	2.000	Gravel	Yes
3	T-634	21, 28, 29, 30	Dago Lake Road	3.000	Asphalt	No
4	T-651	15	Hill Street Road	1.300	Gravel	No
5	T-652	21	Laura Lane	0.250	Gravel	Yes
6	T-654	27, 28, 29	Rush Blvd	2.800	Gravel	No
7	T-748	19	Warbler Lane	0.100	Asphalt	Yes
7	T-748	19	Warbler Lane	0.200	Gravel	Yes
8	T-756	29, 32	Dobosenski Road	1.910	Gravel	Yes
9	T-758	8, 9	Moss Lane	0.720	Gravel	No
10	T-761	3, 4	Island Lake Road	1.770	Asphalt	No
11	T-763	27, 33, 34	Military Road South	2.630	Gravel	No
12	T-770	3, 10	Palon Road	1.490	Asphalt	No
13	T-772	1, 2	Partridge Road North	1.000	Gravel	No
14	T-774	14	Northridge Road	1.000	Gravel	No
15	T-782	12	Lake Twelve Road	1.200	Gravel	No
16	T-828	9	Brandt Road	0.510	Gravel	No
17	T-878	21	Sunset Bay Road	0.100	Gravel	Yes
18	T-881	12	Balsam Road	0.170	Gravel	Yes
19	T-882	4	Twilight Lane	0.630	Asphalt	Yes
20	T-883	4	Warloe Road	0.400	Asphalt	Yes
21	T-902	6	Chestnut Circle	0.750	Asphalt	No
22	T-903	6	Hemlock Lane	0.150	Gravel	No
23	A	4, 5	Lakeshore Drive	0.250	Gravel	Yes
24	B	5	Sunny Beach Road	0.450	Asphalt	Yes
25	D	6	Sunset Lane	0.500	Gravel	Yes
26	E	6	Viking Way	0.450	Asphalt	No
27	F	6	Runestone Lane	0.200	Asphalt	Yes
28	G	6	Paulus Road	0.200	Gravel	Yes
29	H	8	Camp Farm Lane	0.300	Gravel	Yes
30	I	9	Sunrise View Road	0.100	Gravel	Yes
31	J	10	Marview Drive	0.150	Gravel	Yes
32		13, 14	Elm Tree Road South	0.300	Gravel	Yes
33		23, 24	Elm Tree Road North	0.500	Gravel	Yes
34		6	Windemere Way	0.500	Asphalt	No
35		6	Pine Tree Lane	0.200	Asphalt	Yes
36		9	Poplar Lane	0.100	Gravel	No
37		9	Missing link	0.150	Gravel	No

**Subtotal Sheet 1 29.430**

# GRAVEL

## Windemere Township Roads

Page 2 of 2

#	Route	Section(s)	Name	Miles	Type	Dead End
38	K	10	Lakeview Lane	0.450	Gravel	Yes
39	L	10	Cliff Drive	0.380	Gravel	Yes
40	M	11	Heppner Road	0.480	Gravel	Yes
41	N	11, 12	Partridge Road South	1.000	Gravel	No
42	O	16, 21, 22	Sturgeon Island Loop	0.800	Asphalt	No
43	P	21	Marina Beach Drive	0.600	Gravel	Yes
44	Q	21	Victoria Place	0.100	Gravel	Yes
45	T	28	Anchorage Place	0.500	Gravel	No
46	U	28	Valdez Circle	0.100	Gravel	Yes
47	V	28	Cori Lane	0.290	Gravel	No
48	W	28	North Star Drive	1.450	Asphalt	No
49	X	28	Devil's Elbow Road	0.550	Gravel	No
50	Z	28	Pinewood Loop	0.200	Gravel	No
51	AA	28	Woodland Place	0.060	Gravel	Yes
52	BB	28	Fern Lane	0.100	Gravel	No
53	CC	28	Northstar Lane	0.190	Gravel	No
54	DD	28	Teal Drive	0.440	Gravel	No
55	EE	28	Spruce Drive East	0.400	Gravel	No
56	EE	28	Spruce Drive West	0.200	Gravel	No
57	FF	28	Thornbury Lane	0.530	Gravel	No
58	GG	28	Alder Loop	0.980	Gravel	No
59	HH	28	Geneva Road	0.080	Gravel	No
60	II	28	Woodstock Road	0.180	Gravel	No
61	JJ	28	Sheridan Road	0.120	Gravel	No
62	KK	28	Frontier Lane	0.450	Gravel	No
63	LL	28	Hawthorne Court	0.040	Gravel	Yes
64	MM	25, 26	Wetherville Road	0.600	Gravel	Yes
65	NN	10, 15	West Pioneer Road	0.600	Gravel	Yes
66	OO	1, 2, 11, 12	Birchview Road	1.450	Gravel	Yes
67	QQ	11, 12, 13, 14	East Pioneer Road	2.100	Gravel	No
68	RR	6	Lords Drive	0.500	Gravel	No
69	SS	4	Evergreen Road	0.400	Gravel	Yes
70	TT	33	Jackpine Lane	0.600	Gravel	Yes
71	UU	2, 11	Military Road North	1.000	Gravel	No
72	VV	19	Majestic Pine Drive	0.400	Asphalt	Yes
73		6	Settlers Court	0.019	Gravel	Yes
74		6	Settlers Pond Drive	0.100	Gravel	Yes
75		21	Arrow Wood Court	0.010	Gravel	Yes
76		21	Harmony Lane	0.800	Asphalt	No
77		21	Mulberry Lane	0.100	Gravel	No
78		1	Telker Road	0.300	Gravel	Yes
79		5	Parkview Road	0.400	Asphalt	Yes

**Subtotal Sheet 2 20.049**

**Subtotal Sheet 1 29.430**

**Total 49.479**

# of Asphalt Roads 18 Miles of Asphalt Roads 14.790

# of Gravel Roads 61 Miles of Gravel Roads 34.689