

HOW TO LOCATE YOUR PROPERTY LINES

Step 1

To ensure you can dig for your property markers safely you must locate utility lines.

- Gopher State One Call - <http://www.gopherstateonecall.org/> or 1-800-252-1166

They will need a 48-hour notice. This is a free service.

Step 2

Obtain the lot location and dimensions of your property. This information can be found in the following locations.

- County Online GIS Map
- Abstract, Deed or other legal property documents

Step 3

Gather materials you will need to locate property markers including:

- Metal Detector (can be used to find property markers)
- Shovel
- Survey
- Tape Measure

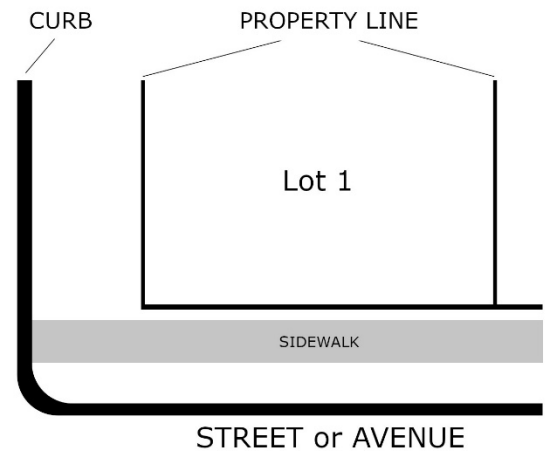

Step 4

Property markers are typically 10-15 feet in from the curb. Go to your front curb and measure to the area you think your marker should be. Use a metal detector and then start digging. The marker should be about 6-14 inches below the surface. Modern lot marking pins may have a colored cap with numbers on the top. Older lot marking pins could be metal posts, rebar, axle irons, pipes, etc.

Step 5

Use your lot dimensions to see what distance the back stake is from the front stake and use your tape measure to measure that distance, then use the metal detector and dig. Continue this process until all stakes are found. Do not rely on trees, bushes, utility poles, sheds, fences or where you mow to identify property lines.

Step 6

If you are unable to find your stakes and/or need to have property markers installed, contact a licensed Professional Land Surveyor. You can look in a phone directory yellow pages for local area land surveying firms.